

LISTA DE APLICACIONES - BUYERS GUIDE

78BD9078-1



Weight: 6.750

O.E.M.	MAKE
3 076 905 8	VOLVO

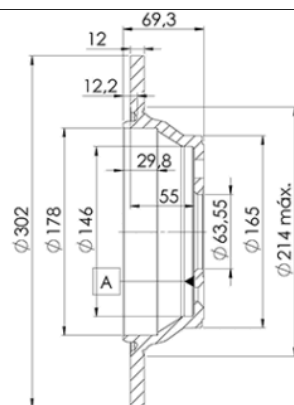
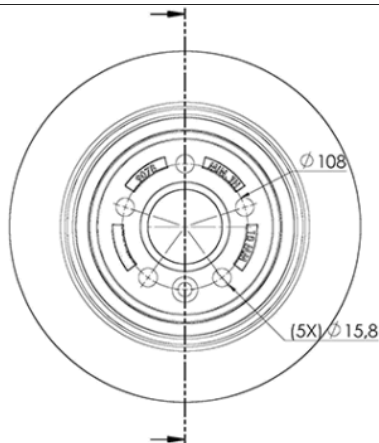

78BD9078-1

E1 90R-02C0241/0557



Ø302x12x69.3

MAKE
MITSUBISHI
VOLVO



Trac.	CC	Kw	CV
-------	----	----	----



Front / Rear

mitsubishi

L 300 II / L300 EXPRESS (L03_P) 02.80-02.87

Van (LCVs-N1 Segment)

1.6	not elec.brak.detent	Gasolina	FWD	1597	50	68	05.80-10.86	■
-----	----------------------	----------	-----	------	----	----	-------------	---

volvo

S80 II (124) 03.06-

Saloon (Executive car-E Segment)

T4 (B 4164 T)	not elec.brak.detent	Gasolina	FWD	1596	132	180	10.10-04.14	■
T5 (B 4204 T15)	not elec.brak.detent	Gasolina	FWD	1969	162	220	01.14-12.16	■
T5 (B 4204 T11)	not elec.brak.detent	Gasolina	FWD	1969	180	245	09.13-05.14	■
2.0 T (B 4204 T6)	not elec.brak.detent	Gasolina	FWD	1999	149	203	01.10-05.11	■
T5 (B 4204 T7)	not elec.brak.detent	Gasolina	FWD	1999	177	241	10.10-12.16	■
2.5 T (B 5254 T14)	not elec.brak.detent	Gasolina	FWD	2497	183	249	09.12-12.16	■
2.5 T (B 5254 T12)	not elec.brak.detent	Gasolina	FWD	2497	187	254	01.12-04.16	■
2.5 T (B 5254 T6)	not elec.brak.detent	Gasolina	FWD	2521	147	200	03.06-12.11	■
2.5 T (B 5254 T10)	not elec.brak.detent	Gasolina	FWD	2521	170	231	01.10-12.12	■
T6 AWD (B 6304 T2)	not elec.brak.detent	Gasolina	4WD	2953	210	286	01.07-12.10	■
T6 AWD (B 6304 T4)	not elec.brak.detent	Gasolina	4WD	2953	224	305	10.10-12.15	■
3.2 (B 6324 S)	not elec.brak.detent	Gasolina	FWD	3192	175	238	03.06-12.10	■
3.2 AWD (B 6324 S)	not elec.brak.detent	Gasolina	4WD	3192	175	238	01.07-12.10	■
3.2 (B 6324 S5)	not elec.brak.detent	Gasolina	FWD	3192	179	243	01.10-12.14	■
3.2 AWD (B 6324 S5)	not elec.brak.detent	Gasolina	4WD	3192	179	243	01.10-12.14	■
4.4 V8 AWD (B 8444 S)	not elec.brak.detent	Gasolina	4WD	4414	232	316	03.06-03.12	■
T4F (B 4164 T2)	not elec.brak.detent	Gasol./Etanol	FWD	1596	132	180	05.11-01.14	■
2.0 FlexFuel (B 4204 S4)	not elec.brak.detent	Gasol./Etanol	FWD	1999	107	146	01.08-12.11	■

LISTA DE APLICACIONES - BUYERS GUIDE

2.5 T FlexFuel (B 5254 T8)	not elec.brak.detent	Gasol./Etanol	FWD	2521	147	200	05.08-12.11	■
2.5 T FlexFuel (B 5254 T11)	not elec.brak.detent	Gasol./Etanol	FWD	2521	170	231	01.10-12.11	■
3.2 Flexifuel AWD		Gasol./Etanol	4WD	3192	177	241	01.09-03.10	■
1.6 D DRIVe (D 4164 T)	not elec.brak.detent	Diesel	FWD	1560	80	109	01.10-12.11	■
1.6 DRIVe (D 4162 T)	not elec.brak.detent	Diesel	FWD	1560	84	114	06.11-01.14	■
D2		Diesel	FWD	1560	85	116	01.14-12.16	■
D4 (D 4204 T5)	not elec.brak.detent	Diesel	FWD	1969	133	181	09.13-12.16	■
D3 (D 5204 T7)		Diesel	FWD	1984	100	136	05.12-05.14	■
D3 / D4 (D 5204 T2)	not elec.brak.detent	Diesel	FWD	1984	120	163	01.10-12.16	■
D3 / D4 (D 5204 T3)	not elec.brak.detent	Diesel	FWD	1984	120	163	01.10-12.16	■
2.0 TDI (D 4204 T)	not elec.brak.detent	Diesel	FWD	1998	100	136	02.08-03.11	■
2.4 D (D 5244 T19)	not elec.brak.detent	Diesel	FWD	2400	120	163	03.06-03.11	■
2.4 D (D 5244 T5)	not elec.brak.detent	Diesel	FWD	2400	120	163	03.06-03.11	■
2.4 D (D 5244 T14)	not elec.brak.detent	Diesel	FWD	2400	129	175	01.10-03.11	■
D5 (D 5244 T4)	not elec.brak.detent	Diesel	FWD	2400	136	185	03.06-08.09	■
D5 AWD (D 5244 T4)	not elec.brak.detent	Diesel	4WD	2400	136	185	01.07-05.09	■
D5 (D 5244 T10)	not elec.brak.detent	Diesel	FWD	2400	151	205	01.10-12.11	■
D5 AWD (D 5244 T10)	not elec.brak.detent	Diesel	4WD	2400	151	205	01.10-12.11	■
D5 (D 5244 T11)	not elec.brak.detent	Diesel	FWD	2400	158	215	06.11-04.15	■
D5 (D 5244 T15)	not elec.brak.detent	Diesel	FWD	2400	158	215	06.11-04.15	■
D5 AWD (D 5244 T15)	not elec.brak.detent	Diesel	4WD	2400	158	215	06.11-04.15	■
V70 III (135) 09.13-					Estate Van (Executive car-E Segment)			
2.0 D3 DRIVe (D 5204 T7)	not elec.brak.detent	Diesel	FWD	1984	100	136	09.13-12.15	■
2.4 D4	not elec.brak.detent	Diesel	FWD	2400	120	163	09.13-	■
2.4 D4 AWD	not elec.brak.detent	Diesel	4WD	2400	120	163	09.13-12.15	■
2.4 D5 (D 5244 T11)	not elec.brak.detent	Diesel	FWD	2400	158	215	09.13-12.15	■
2.4 D5 (D 5244 T15)	not elec.brak.detent	Diesel	FWD	2400	158	215	09.13-12.15	■
V70 III (135) 04.07-					Estate (Executive car-E Segment)			
T4 (B 4164 T)	not elec.brak.detent	Gasolina	FWD	1596	132	180	10.10-12.15	■
T4 (B 4204 T19)	not elec.brak.detent	Gasolina	FWD	1969	140	190	03.15-04.16	■
T5 (B 4204 T11)	not elec.brak.detent	Gasolina	FWD	1969	180	245	10.13-04.16	■
2.0 (B 4204 S3)	not elec.brak.detent	Gasolina	FWD	1999	107	145	10.07-12.11	■
2.0 T (B 4204 T6)	not elec.brak.detent	Gasolina	FWD	1999	149	203	09.09-12.11	■
T5 (B 4204 T7)	not elec.brak.detent	Gasolina	FWD	1999	177	241	01.10-12.14	■
2.5 T (B 5254 T6)	not elec.brak.detent	Gasolina	FWD	2521	147	200	08.07-12.09	■
2.5 T (B 5254 T10)	not elec.brak.detent	Gasolina	FWD	2521	170	231	04.09-12.12	■
T6 AWD (B 6304 T2)	not elec.brak.detent	Gasolina	4WD	2953	210	286	08.07-12.10	■
T6 AWD (B 6304 T4)	not elec.brak.detent	Gasolina	4WD	2953	224	305	01.10-12.15	■
T6 AWD (B 6304 T4)		Gasolina	4WD	2953	242	329	11.13-04.16	■
3.2 (B 6324 S)	not elec.brak.detent	Gasolina	FWD	3192	175	238	08.07-12.10	■
3.2 AWD (B 6324 S)	not elec.brak.detent	Gasolina	4WD	3192	175	238	04.07-12.10	■
3.2 (B 6324 S5)	not elec.brak.detent	Gasolina	FWD	3192	179	243	04.10-12.14	■
3.2 AWD (B 6324 S5)	not elec.brak.detent	Gasolina	4WD	3192	179	243	04.10-12.15	■
2.0 BiFuel (B 5204 T9)		Gasol./Gas (LPG)	FWD	1984	157	214	03.13-12.15	■
T4F (B 4164 T2)	not elec.brak.detent	Gasol./Etanol	FWD	1596	132	180	01.11-12.15	■
2.0 FlexiFuel (B 4204 S4)	not elec.brak.detent	Gasol./Etanol	FWD	1999	107	146	01.08-12.11	■
2.5 T FlexiFuel (B 5254 T8)	not elec.brak.detent	Gasol./Etanol	FWD	2521	147	200	05.08-12.09	■

LISTA DE APLICACIONES - BUYERS GUIDE

2.5 T FlexiFuel (B 5254 T11)	not elec.brak.detent	Gasol./Etanol	FWD	2521	170	231	04.09-12.11	■
1.6 D (D 4164 T)	not elec.brak.detent	Diesel	FWD	1560	80	109	07.09-12.11	■
1.6 DRIVe / D2 (D 4162 T)	not elec.brak.detent	Diesel	FWD	1560	84	114	04.11-12.15	■
D2 (D 4204 T20)	not elec.brak.detent	Diesel	FWD	1969	88	120	03.15-04.16	■
D3 (D 4204 T9)	not elec.brak.detent	Diesel	FWD	1969	110	150	03.15-04.16	■
D4 (D 4204 T5)	not elec.brak.detent	Diesel	FWD	1969	133	181	10.13-04.16	■
D3 (D 5204 T7)	not elec.brak.detent	Diesel	FWD	1984	100	136	10.07-12.15	■
2.0 D (D 4204 T)	not elec.brak.detent	Diesel	FWD	1998	100	136	10.07-12.15	■
2.4 D (D 5244 T19)	not elec.brak.detent	Diesel	FWD	2400	120	163	04.07-12.10	■
2.4 D (D 5244 T5)	not elec.brak.detent	Diesel	FWD	2400	120	163	04.07-12.10	■
D4 AWD (D 5244 T17)	not elec.brak.detent	Diesel	4WD	2400	120	163	10.07-12.15	■
2.4 D (D 5244 T14)	not elec.brak.detent	Diesel	FWD	2400	129	175	04.09-12.10	■
D4 AWD (D 5244 T12)	not elec.brak.detent	Diesel	4WD	2400	133	181	10.13-04.16	■
D5 (D 5244 T4)	not elec.brak.detent	Diesel	FWD	2400	136	185	04.07-12.09	■
D5 (D 5244 T10)	not elec.brak.detent	Diesel	FWD	2400	151	205	10.08-12.11	■
D5 AWD (D 5244 T10)	not elec.brak.detent	Diesel	4WD	2400	151	205	12.09-12.11	■
D5 (D 5244 T11)	not elec.brak.detent	Diesel	FWD	2400	158	215	04.11-12.15	■
D5 (D 5244 T15)	not elec.brak.detent	Diesel	FWD	2400	158	215	04.11-12.15	■
D5 AWD (D 5244 T15)	not elec.brak.detent	Diesel	4WD	2400	158	215	04.11-12.15	■
D5	not elec.brak.detent	Diesel	FWD	2400	169	230	03.11-04.16	■
D5 AWD	not elec.brak.detent	Diesel	4WD	2400	169	230	03.11-04.16	■
D5 AWD (D 5244 T4)	not elec.brak.detent	Diesel	4WD	2401	136	185	04.07-12.09	■
XC70 III (136) 04.07-					Estate (Executive car-E Segment)			
T5 (B 4204 T11)	not elec.brak.detent	Gasolina	FWD	1969	180	245	10.13-12.16	■
T6 AWD (B 5254 T14)		Gasolina	4WD	2497	183	249	03.15-12.16	■
T5 AWD (B 5254 T12)		Gasolina	4WD	2497	187	254	08.15-12.16	■
T6 AWD (B 6304 T2)	not elec.brak.detent	Gasolina	4WD	2953	210	286	01.08-12.16	■
T6 AWD (B 6304 T4)	not elec.brak.detent	Gasolina	4WD	2953	224	304	01.10-04.15	■
T6 Polestar AWD		Gasolina	4WD	2953	242	329	11.13-12.16	■
3.2	not elec.brak.detent	Gasolina	FWD	3192	171	233	09.10-12.12	■
3.2 AWD (B 6324 S)	not elec.brak.detent	Gasolina	4WD	3192	175	238	08.07-12.11	■
3.2	not elec.brak.detent	Gasolina	FWD	3192	179	243	08.07-	■
3.2 AWD (B 6324 S5)	not elec.brak.detent	Gasolina	4WD	3192	179	243	05.10-12.14	■
D4 (D 4204 T5)	not elec.brak.detent	Diesel	FWD	1969	133	181	10.13-04.16	■
D3 (D 5204 T2)	not elec.brak.detent	Diesel	FWD	1984	120	163	04.10-12.15	■
D3 (D 5204 T3)	not elec.brak.detent	Diesel	FWD	1984	120	163	04.10-12.15	■
D3	not elec.brak.detent	Diesel	RWD	1984	120	163	08.11-	■
2.4 D / D4 AWD (D 5244 T16)	not elec.brak.detent	Diesel	4WD	2400	120	163	08.07-04.16	■
2.4 D / D4 AWD (D 5244 T17)	not elec.brak.detent	Diesel	4WD	2400	120	163	08.07-04.16	■
2.4 D / D4 AWD (D 5244 T5)	not elec.brak.detent	Diesel	4WD	2400	120	163	08.07-04.16	■
2.4 D (D 5244 T14)	not elec.brak.detent	Diesel	FWD	2400	129	175	06.09-12.10	■
D4 AWD (D 5244 T12)	not elec.brak.detent	Diesel	4WD	2400	133	181	10.13-04.16	■
D5 AWD (D 5244 T4)	not elec.brak.detent	Diesel	4WD	2400	136	185	04.07-12.09	■
D5 AWD (D 5244 T10)	not elec.brak.detent	Diesel	4WD	2400	151	205	04.09-12.11	■
D5 AWD (D 5244 T11)	not elec.brak.detent	Diesel	4WD	2400	158	215	04.11-12.15	■
D5 AWD (D 5244 T15)	not elec.brak.detent	Diesel	4WD	2400	158	215	04.11-12.15	■
D5 AWD (D 5244 T20)	not elec.brak.detent	Diesel	4WD	2400	162	220	03.15-04.16	■
D5 AWD (D 5244 T15)		Diesel	4WD	2400	169	230	11.13-04.16	■