

LISTA DE APLICACIONES - BUYERS GUIDE

78BD9116-2



Weight: 7.636

| O.E.M. | MAKE |
|------------|----------|
| 5 69 116 | OPEL |
| 93 176 548 | VAUXHALL |

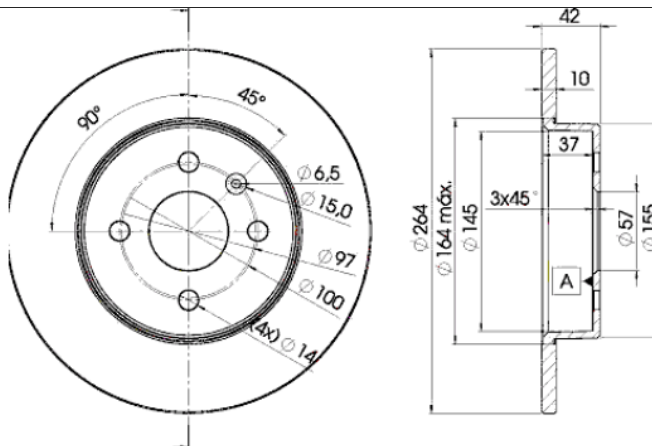

78BD9116-2

E1 90R-02C0415/0009



Ø264x10x42

| MAKE |
|-----------|
| CHEVROLET |
| OPEL |
| VAUXHALL |



| Trac. | CC | Kw | CV |
|-------|----|----|----|
|-------|----|----|----|



Front / Rear

CHEVROLET

MERIVA 02.02-07.12

MPV (Mini MPV-M1 Segment)

| | | | | | | | |
|---------------|---------------|-----|------|----|-----|-------------|---|
| 1.8 | Gasolina | FWD | 1796 | 82 | 111 | 03.03-07.12 | ■ |
| 1.8 Flex (75) | Gasol./Etanol | FWD | 1796 | 84 | 114 | 09.05-07.12 | ■ |

OPEL

ASTRA H TwinTop (A04) 09.05-12.13

Convertible (Compact car-C Segment)

| | | | | | | | |
|----------------------|----------|-----|------|----|----|-------------|---|
| 1.4 (L67) (Z 14 XEP) | Gasolina | FWD | 1364 | 66 | 90 | 10.05-10.10 | ■ |
|----------------------|----------|-----|------|----|----|-------------|---|

COMBO C 10.01-

Box Body/MPV (LCVs-N1 Segment)

| | | | | | | | |
|-------------------------|------------------|-----|------|----|----|-------------|---|
| 1.4 16V (Z 14 XEP) | Gasolina | FWD | 1364 | 66 | 90 | 08.05- | ■ |
| 1.6 (Z 16 SE) | Gasolina | FWD | 1598 | 64 | 87 | 10.01- | ■ |
| 1.6 CNG 16V (Z 16 YNG) | Gasol./Gas (CNG) | FWD | 1598 | 69 | 94 | 06.06- | ■ |
| 1.6 CNG 16V (Z 16 YNG) | Gasol./Gas (CNG) | FWD | 1598 | 71 | 97 | 04.05- | ■ |
| 1.3 CDTI 16V (Z 13 DT) | Diesel | FWD | 1248 | 51 | 69 | 08.05- | ■ |
| 1.3 CDTI 16V (Z 13 DTJ) | Diesel | FWD | 1248 | 55 | 75 | 10.05-12.12 | ■ |
| 1.7 DI 16V (Y 17 DTL) | Diesel | FWD | 1686 | 48 | 65 | 10.01- | ■ |
| 1.7 DTI 16V (Y 17 DT) | Diesel | FWD | 1686 | 55 | 75 | 10.01- | ■ |

COMBO C Tour 10.01-

MPV (Large MPV-M1 Segment)

| | | | | | | | |
|----------------|----------|-----|------|----|----|-------------|---|
| 1.4 (Z 14 XEP) | Gasolina | FWD | 1364 | 66 | 90 | 10.04-12.11 | ■ |
| 1.6 | Gasolina | FWD | 1598 | 62 | 84 | 10.01-09.06 | ■ |
| 1.6 (Z 16 SE) | Gasolina | FWD | 1598 | 64 | 87 | 10.01-09.06 | ■ |

LISTA DE APLICACIONES - BUYERS GUIDE

| | | | | | | | | | |
|---|--|------------------|-----|------|----|-----|--|---|--|
| 1.6 CNG (Z 16 YNG) | | Gasol./Gas (CNG) | FWD | 1598 | 69 | 94 | 06.06-12.11 | ■ | |
| 1.6 CNG (Z 16 YNG) | | Gasol./Gas (CNG) | FWD | 1598 | 71 | 97 | 04.05-01.11 | ■ | |
| 1.3 CDTI 16V (Y 13 DT) | | Diesel | FWD | 1248 | 51 | 69 | 06.04-01.11 | ■ | |
| 1.3 CDTI 16V (Z 13 DT) | | Diesel | FWD | 1248 | 51 | 69 | 06.04-01.11 | ■ | |
| 1.3 CDTI 16V (Z 13 DTJ) | | Diesel | FWD | 1248 | 55 | 75 | 10.05-12.11 | ■ | |
| 1.7 DI 16V (Y 17 DTL) | | Diesel | FWD | 1686 | 48 | 65 | 10.01-06.04 | ■ | |
| 1.7 DTI 16V (Y 17 DT) | | Diesel | FWD | 1686 | 55 | 75 | 10.01-06.04 | ■ | |
| CORSA C / VITA C (X01) 09.00-12.09 | | | | | | | Hatchback (Supermini car-B Segment) | | |
| 1.6 (F08, F68) | | Gasolina | FWD | 1598 | 62 | 84 | 09.00-12.09 | ■ | |
| 1.8 (F08, F68) (Z 18 XEL) | | Gasolina | FWD | 1796 | 79 | 107 | 01.02-12.09 | ■ | |
| MERIVA A (X03) 05.03-05.10 | | | | | | | MPV (Mini MPV-M1 Segment) | | |
| 1.6 16V (E75) (Z 16 XE) | | Gasolina | FWD | 1598 | 74 | 100 | 05.03-01.06 | ■ | |
| 1.6 (E75) (Z 16 XEP) | | Gasolina | FWD | 1598 | 77 | 105 | 01.06-05.10 | ■ | |
| 1.8 (E75) (Z 18 XE) | | Gasolina | FWD | 1796 | 92 | 125 | 05.03-05.10 | ■ | |
| 1.3 CDTI (E75) (Y 13 DT) | | Diesel | FWD | 1248 | 51 | 69 | 04.05-05.10 | ■ | |
| 1.3 CDTI (E75) (Z 13 DT) | | Diesel | FWD | 1248 | 51 | 69 | 04.05-05.10 | ■ | |
| 1.3 CDTI (E75) (Z 13 DTJ) | | Diesel | FWD | 1248 | 55 | 75 | 09.03-05.10 | ■ | |
| 1.7 DTI (E75) (Y 17 DT) | | Diesel | FWD | 1686 | 55 | 75 | 09.03-05.10 | ■ | |
| VAUXHALL | | | | | | | | | |
| COMBO Mk II (C) (F25) 09.01-02.12 | | | | | | | Box Body/MPV (LCVs-N1 Segment) | | |
| 1.4 i 16V (Z 14 XEP) | | Gasolina | FWD | 1364 | 66 | 90 | 01.04-11.11 | ■ | |
| 1.4 16V (Z 14 XE) | | Gasolina | FWD | 1389 | 66 | 90 | 10.01-05.07 | ■ | |
| 1.6 (Z 16 SE) | | Gasolina | FWD | 1598 | 62 | 84 | 09.01-10.04 | ■ | |
| 1.6 (Z 16 SE) | | Gasolina | FWD | 1598 | 64 | 87 | 10.01-11.11 | ■ | |
| 1.6 CNG 16V (Y 16 YNG) | | Gasol./Gas (CNG) | FWD | 1598 | 69 | 94 | 06.06-02.12 | ■ | |
| 1.6 CNG 16V (Z 16 YNG) | | Gasol./Gas (CNG) | FWD | 1598 | 69 | 94 | 06.06-02.12 | ■ | |
| 1.6 CNG 16V (Z 16 YNG) | | Gasol./Gas (CNG) | FWD | 1598 | 71 | 97 | 04.05-02.12 | ■ | |
| 1.3 CDTI 16V (Y 13 DT) | | Diesel | FWD | 1248 | 51 | 69 | 09.04-02.12 | ■ | |
| 1.3 CDTI 16V (Z 13 DT) | | Diesel | FWD | 1248 | 51 | 69 | 09.04-02.12 | ■ | |
| 1.3 CDTI 16V (Z 13 DTJ) | | Diesel | FWD | 1248 | 55 | 75 | 10.05-11.11 | ■ | |
| 1.7 DI 16V (Y 17 DTL) | | Diesel | FWD | 1686 | 48 | 65 | 09.01-11.11 | ■ | |
| 1.7 DTI 16V (Y 17 DT) | | Diesel | FWD | 1686 | 55 | 75 | 10.01-11.11 | ■ | |
| COMBO TOUR Mk II (C) (F25) 09.01-02.12 | | | | | | | MPV (Large MPV-M1 Segment) | | |
| 1.4 (Z 14 XEP) | | Gasolina | FWD | 1364 | 66 | 90 | 10.04-09.10 | ■ | |
| 1.6 (Z 16 SE) | | Gasolina | FWD | 1598 | 64 | 87 | 10.01-06.04 | ■ | |
| 1.6 CNG (Z 16 YNG) | | Gasol./Gas (CNG) | FWD | 1598 | 69 | 94 | 06.06-09.10 | ■ | |
| 1.6 CNG (Z 16 YNG) | | Gasol./Gas (CNG) | FWD | 1598 | 71 | 97 | 04.05-02.12 | ■ | |
| 1.3 CDTI 16V (Z 13 DT) | | Diesel | FWD | 1248 | 51 | 69 | 09.04-09.06 | ■ | |
| 1.3 CDTI 16V (Z 13 DTJ) | | Diesel | FWD | 1248 | 55 | 75 | 07.06-02.12 | ■ | |
| 1.7 DI 16V (Y 17 DTL) | | Diesel | FWD | 1686 | 48 | 65 | 09.01-06.04 | ■ | |
| 1.7 DTI 16V (Y 17 DT) | | Diesel | FWD | 1686 | 55 | 75 | 10.01-02.12 | ■ | |

LISTA DE APLICACIONES - BUYERS GUIDE

| CORSA Mk II (C) (X01) 08.00-04.07 | | | | | Hatchback (Supermini car-B Segment) | | | |
|---|--------|----------|-----|------|--|-----|-------------|---|
| 1.4 Twinport (F08, F68) (Z 14 XEP) | | Gasolina | FWD | 1364 | 66 | 90 | 06.03-10.06 | ■ |
| CORSAVAN Mk II (C) (X01) 09.00-11.06 | | | | | Hatchback Van (LCVs-N1 Segment) | | | |
| 1.7 DI 16V (F08) (Y 17 DTL) | 08/01- | Diesel | FWD | 1686 | 48 | 65 | 09.00-06.06 | ■ |
| 1.7 DTI 16V (F08) (Y 17 DT) | 08/01- | Diesel | FWD | 1686 | 55 | 75 | 09.00-06.06 | ■ |
| MERIVA Mk I (A) (X03) 01.03-06.10 | | | | | MPV (Mini MPV-M1 Segment) | | | |
| 1.6 i 16V (Z 16 XE) | | Gasolina | FWD | 1598 | 74 | 100 | 01.03-09.05 | ■ |
| 1.6 i 16V Twinport (Z 16 XEP) | | Gasolina | FWD | 1598 | 77 | 105 | 05.03-06.10 | ■ |
| 1.8 i 16V (Z 18 XE) | | Gasolina | FWD | 1796 | 92 | 125 | 05.03-06.10 | ■ |
| 1.3 CDTi (Y 13 DT) | | Diesel | FWD | 1248 | 51 | 69 | 04.05-06.10 | ■ |
| 1.3 CDTi (Z 13 DT) | | Diesel | FWD | 1248 | 51 | 69 | 04.05-06.10 | ■ |
| 1.3 CDTi (Z 13 DTJ) | 04/06- | Diesel | FWD | 1248 | 55 | 75 | 01.03-10.09 | ■ |
| 1.7 DTI (Y 17 DT) | | Diesel | FWD | 1686 | 55 | 75 | 06.03-06.10 | ■ |