

LISTA DE APLICACIONES - BUYERS GUIDE

78BD9196-2



Weight: 18.380

O.E.M.	MAKE
00K04779196AG	CHRYSLER
4779196AB	DODGE
4779196AD	CHRYSLER
4779196AE	CHRYSLER
4779196AF	CHRYSLER
K04779196AD	CHRYSLER
K04779196AE	CHRYSLER
K04779196AF	CHRYSLER

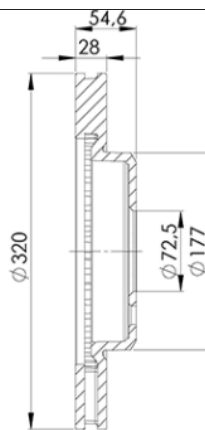
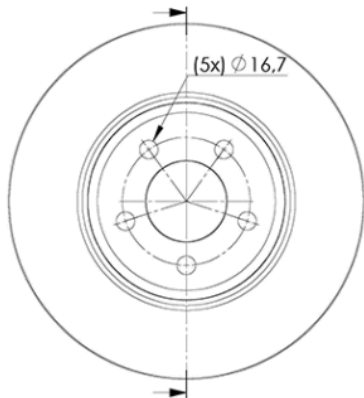

78BD9196-2

E1 90R-02C0074/1462



Ø320x28x54.6

MAKE
CHRYSLER
DODGE



Trac.	CC	Kw	CV
-------	----	----	----



Front / Rear

CHRYSLER

300 (U.S.A.) 09.04-12.11

Saloon (Luxury car-F Segment)

5.7	Eq.V_ BR4	Gasolina	FWD		254	345	09.04-12.07	■
-----	-----------	----------	-----	--	-----	-----	-------------	---

300 C (LX, LE) 09.04-

Saloon (Luxury car-F Segment)

2.7 (EES)	Eq.V_ BR4	Gasolina	RWD	2736	130	177	01.07-11.12	■
2.7	Eq.V_ BR4	Gasolina	FWD	2736	133	181	09.09-12.10	■
2.7 (EER)	Eq.V_ BR4	Gasolina	RWD	2736	142	193	09.04-12.12	■
3.5 (EGG)	Eq.V_ BR4	Gasolina	RWD	3518	183	249	09.04-11.12	■
3.5	Eq.V_ BR4	Gasolina	RWD	3518	186	253	01.05-12.10	■
3.5 AWD (EGG)	Eq.V_ BR4	Gasolina	4WD	3518	186	253	09.04-12.10	■
5.7 (EZB)	Eq.V_ BR4	Gasolina	RWD	5654	250	340	09.04-12.08	■
5.7 (EZD)	Eq.V_ BR4	Gasolina	RWD	5654	250	340	09.04-12.08	■
5.7 (EZH)	Eq.V_ BR4	Gasolina	RWD	5654	250	340	09.04-12.08	■
5.7	Eq.V_ BR4	Gasolina	FWD	5654	250	340	09.04-08.08	■
5.7	Eq.V_ BR4	Gasolina	FWD	5654	256	348	12.09-11.12	■
5.7 (EZH)	Eq.V_ BR4	Gasolina	RWD	5654	268	364	09.08-	■
5.7 AWD (EZD)	Eq.V_ BR4	Gasolina	4WD	5654	268	364	09.08-	■
6.1 SRT8 (ESF)	Eq.V_ BR4	Gasolina	RWD	6059	317	431	06.05-11.12	■
3.0 V6 CRD (EXL)	Eq.V_ BR4	Diesel	RWD	2987	155	211	11.10-11.12	■
3.0 CRD (EXL)	Eq.V_ BR4	Diesel	RWD	2987	160	218	09.05-11.12	■

300 C II (LX) 09.10-

Saloon (Luxury car-F Segment)

3.6 (ERB)	Eq.V_ BR3	Gasolina	RWD	3604	210	286	09.11-08.19	■
3.6 (ERB)	Eq.V_ BR3	Gasolina	RWD	3604	215	292	07.11-12.23	■
3.6		Gasolina	RWD	3604	216	294	04.15-12.23	■

LISTA DE APLICACIONES - BUYERS GUIDE

3.6 (ERB)	Eq.V_ BR3	Gasolina	RWD	3604	218	296	01.11-12.23	■	
5.7 AWD		Gasolina	4WD	5654	271	369	09.10-	■	
6.4 SRT8 (ESG)		Gasolina	RWD	6417	350	476	09.11-	■	
6.4	Eq.V_ BR3	Gasolina	FWD	6424	401	545	01.12-	■	
3.6 Flexfuel (ERB)		Gasol./Etanol	RWD	3604	218	296	09.10-	■	
300 C Touring (LX, LE) 09.04-12.10					Estate (Luxury car-F Segment)				
2.7 (EES)	Eq.V_ BR4	Gasolina	RWD	2736	130	177	01.07-12.10	■	
2.7 (EER)	Eq.V_ BR4	Gasolina	RWD	2736	142	193	09.04-12.10	■	
3.5 (EGG)	Eq.V_ BR4	Gasolina	RWD	3518	183	249	09.04-12.10	■	
5.7 (EZB)	Eq.V_ BR4	Gasolina	RWD	5654	250	340	09.04-12.10	■	
5.7 (EZD)	Eq.V_ BR4	Gasolina	RWD	5654	250	340	09.04-12.10	■	
5.7 (EZH)	Eq.V_ BR4	Gasolina	RWD	5654	250	340	09.04-12.10	■	
5.7 AWD (EZB)	Eq.V_ BR4	Gasolina	4WD	5654	250	340	04.05-12.10	■	
5.7 AWD (EZH)	Eq.V_ BR4	Gasolina	4WD	5654	250	340	04.05-12.10	■	
6.1 SRT8 (ESF)	Eq.V_ BR4	Gasolina	RWD	6059	317	431	06.05-12.10	■	
3.0 CRD (EXL)	Eq.V_ BR4	Diesel	RWD	2987	160	218	09.05-12.10	■	
DODGE									
CHALLENGER III 09.07-					Coupe (Supermini car-B Segment)				
6.1 SRT8 (ESF)		Gasolina	RWD	6059	313	426	01.08-	■	
6.1 SRT8 (ESF)		Gasolina	RWD	6059	317	431	09.07-	■	
6.4 (ESG)		Gasolina	RWD	6417	362	492	09.14-	■	
6.4 (ESH)		Gasolina	RWD	6417	362	492	09.14-	■	
CHARGER VI 06.05-12.10					Saloon (Luxury car-F Segment)				
2.7		Gasolina	RWD	2736	133	181	09.08-12.10	■	
2.7 (EER)	Eq.V_ BR4	Gasolina	RWD	2736	141	192	04.06-12.10	■	
3.5 (EGG)	Eq.V_ BR4	Gasolina	RWD	3518	186	253	06.05-12.10	■	
5.7 R/T (EZA)	Eq.V_ BR4	Gasolina	RWD	5654	254	345	06.05-12.08	■	
5.7 R/T AWD		Gasolina	4WD	5654	276	375	09.08-12.10	■	
CHARGER VII 09.10-					Saloon (Luxury car-F Segment)				
3.6 (ERB)		Gasolina	RWD	3604	215	292	06.12-	■	
3.6 (ERB)		Gasolina	RWD	3604	218	296	01.11-	■	
5.7 (EZH)		Gasolina	RWD	5654	272	370	06.12-	■	
5.7 R/T (EZH)		Gasolina	RWD	5654	276	375	09.10-	■	
5.7 Flexfuel (EZH)		Gasol./Etanol	RWD	5654	276	375	09.10-12.14	■	