

LISTA DE APLICACIONES - BUYERS GUIDE

78BD9269-2



Weight: 21.180

O.E.M.	MAKE
052089269AB	JEEP
52089269AB	JEEP

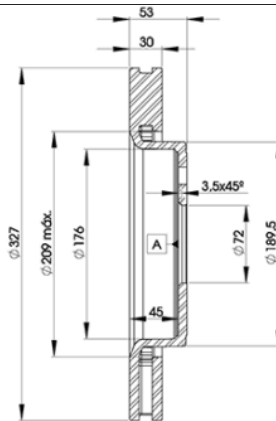
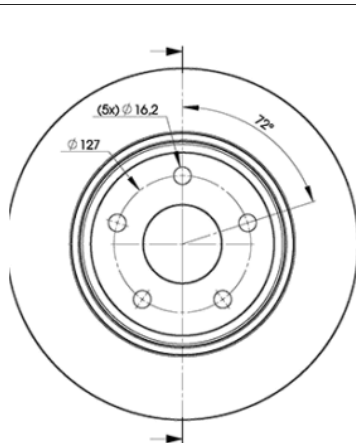

78BD9269-2

E1 90R-02C0289/1576



Ø327x30x53

MAKE
JEEP



Trac.	CC	Kw	CV
-------	----	----	----



Front / Rear

JEEP

COMMANDER (XK, XH) 09.05-12.10

				SUV (Pick-Up Truck)					
3.7 V6 4x4 (EKG)		Gasolina	4WD	3701	157	214	09.05-12.10		■
4.7 V8 4x4 (EVA)		Gasolina	4WD	4701	170	231	09.05-12.10		■
4.7 Flexfuel		Gasolina	FWD	4701	175	238	09.06-12.07		■
4.7 Flexfuel		Gasolina	FWD	4701	175	238	09.06-12.07		■
4.7 V8 4x4 (EVE)		Gasolina	4WD	4701	223	303	01.08-12.09		■
5.7 V8 4x4 (EZB)		Gasolina	4WD	5654	240	326	09.05-12.10		■
5.7 HEMI 4x4 (EZH)		Gasolina	4WD	5654	255	347	06.09-12.10		■
3.0 CRD 4x4		Diesel	4WD	2987	155	211	09.05-12.10		■
3.0 CRD 4x4 (EXL)		Diesel	4WD	2987	160	218	04.06-12.10		■

COMMANDER VAN (XH) 09.05-12.10

				SUV Van (Pick-Up Truck)					
5.7 HEMI V8 4x4		Gasolina	4WD	5654	240	326	09.05-12.10		■
3.0 CRD 4x4		Diesel	4WD	2987	160	218	09.05-12.10		■

GRAND CHEROKEE II (WJ, WG) 09.98-09.05

				Closed Off-Road Vehicle (Luxury Crossover SUV-J Segment)					
3.7 Laredo		Gasolina	FWD	3700	157	213	10.04-09.05		■
4.7		Gasolina	FWD	4701	167	227	10.04-09.05		■
4.7 V8 4x4 (EVA)	06/05-	Gasolina	4WD	4701	167	227	06.03-09.05		■
4.7 V8 4x4 (EVC)	06/05-	Gasolina	4WD	4701	190	258	10.01-09.05		■

GRAND CHEROKEE III (WH, WK) 10.04-10.11

				Closed Off-Road Vehicle (Luxury Crossover SUV-J Segment)					
3.7 V6 4x4 (EKG)		Gasolina	4WD	3700	148	201	01.08-12.10		■
3.7 V6 (EKG)		Gasolina	RWD	3701	157	214	10.04-12.10		■
3.7 V6 4x4 (EKG)		Gasolina	4WD	3701	157	214	10.04-12.10		■

LISTA DE APLICACIONES - BUYERS GUIDE

4.7 V8 4x4 (EVA)		Gasolina	4WD	4701	164	223	06.05-12.10	■
4.7 V8 (EVA)		Gasolina	RWD	4701	167	227	10.04-05.10	■
4.7 V8 (EVE)		Gasolina	RWD	4701	167	227	10.04-05.10	■
4.7 V8 4x4 (EVE)		Gasolina	4WD	4701	167	227	10.07-05.10	■
4.7 V8 4x4 (EVA)		Gasolina	4WD	4701	170	231	06.05-12.10	■
4.7 V8 4x4 (EVA)		Gasolina	4WD	4701	223	303	09.07-02.10	■
4.7 V8 4x4 (EVE)		Gasolina	4WD	4701	223	303	09.07-02.10	■
4.7 4WD		Gasolina	4WD	4701	227	309	09.07-12.08	■
5.7 (EZB)		Gasolina	RWD	5654	240	326	06.05-12.08	■
5.7 V8 4x4 (EZB)		Gasolina	4WD	5654	240	326	06.05-12.10	■
5.7 V8 4x4 (EZD)		Gasolina	4WD	5654	259	352	01.09-12.10	■
5.7 V8 4x4 (EZH)		Gasolina	4WD	5654	259	352	01.09-12.10	■
5.7 V8 4x4 (EZD)		Gasolina	4WD	5654	265	360	01.09-12.10	■
5.7 V8 4x4 (EZH)		Gasolina	4WD	5654	269	366	01.09-12.10	■
4.7 V8 FLEX (EVA)		Gasol./Etanol	RWD	4701	167	227	10.04-05.10	■
4.7 V8 FLEX (EVD)		Gasol./Etanol	RWD	4701	167	227	10.04-05.10	■
4.7 V8 FLEX (EVE)		Gasol./Etanol	RWD	4701	167	227	10.04-05.10	■
3.0 CRD 4x4 (EXL)		Diesel	4WD	2987	132	180	05.06-12.10	■
3.0 CRD 4x4 (EXL)		Diesel	4WD	2987	155	211	05.06-12.10	■
3.0 CRD (EXL)		Diesel	RWD	2987	160	218	06.05-12.10	■
3.0 CRD 4x4 (EXL)		Diesel	4WD	2987	160	218	06.05-12.10	■
3.0 CRD 4x4		Diesel	4WD	2987	165	224	03.05-10.11	■
GRAND CHEROKEE IV (WK, WK2) 06.10-					SUV (Luxury Crossover SUV-J Segment)			
3.6 V6 FlexFuel 4x4 (ERB)		Gasol./Etanol	4WD	3604	210	286	11.10-	■