

LISTA DE APLICACIONES - BUYERS GUIDE

78BD9284-2



8 424073 149503

Weight: 7.850

O.E.M.	MAKE
MB 587 432	MITSUBISHI
MB 587 433	MITSUBISHI

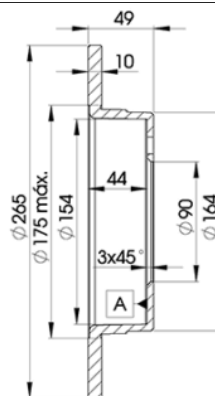

78BD9284-2



Ø265x10x49

MAKE
MITSUBISHI



Trac.	CC	Kw	CV
-------	----	----	----



Front / Rear

MITSUBISHI

ECLIPSE I (D2_A) 12.89-12.95

Coupe (Executive car-E Segment)

1.8 (D21A) (4G37)	Gasolina	FWD	1755	68	92	12.89-03.94	■
2.0 i 16V (D22A, D27A) (4G63 (DOHC 16V))	Gasolina	FWD	1997	110	150	04.91-11.95	■
2.0 i 16V 4WD (D22A, D27A) (4G63 (DOHC 16V))	Gasolina	4WD	1997	110	150	04.91-11.95	■
2.0 Turbo 4WD	Gasolina	4WD	1997	157	214	12.89-03.94	■

ECLIPSE II (D3_A) 04.94-04.99

Coupe (Executive car-E Segment)

2000 GS 16V (D32A) (4G63 (DOHC 16V))	Gasolina	FWD	1997	107	146	12.95-04.99	■
2000 GT 16V (4G63-T (DOHC 16V))	Gasolina	FWD	1997	157	214	12.95-04.99	■
2400 GS 16V (4G64 (16V))	Gasolina	FWD	2389	105	143	09.98-04.99	■

GALANT VIII / ASPIRE (EA_) 09.96-10.04

Saloon (Executive car-E Segment)

2.5 V6 24V (EA5A) (6A13)	Gasolina	FWD	2498	118	160	09.00-10.04	■
2.5 V6 24V (EA5A) (6A13)	Gasolina	FWD	2498	120	163	09.96-09.00	■

GALANT VIII / LEGNUM (EA_, EC_) 09.96-10.03

Estate (Executive car-E Segment)

2.5 V6 24V (EA5W) (6A13)	Gasolina	FWD	2498	118	160	09.00-10.03	■
2.5 V6 24V (EA5W) (6A13)	Gasolina	FWD	2498	120	163	09.96-09.00	■