

# LISTA DE APLICACIONES - BUYERS GUIDE

## 78BD9718-2



Weight: 8.596

O.E.M.	MAKE
4509552	CHRYSLER
4509718	CHRYSLER

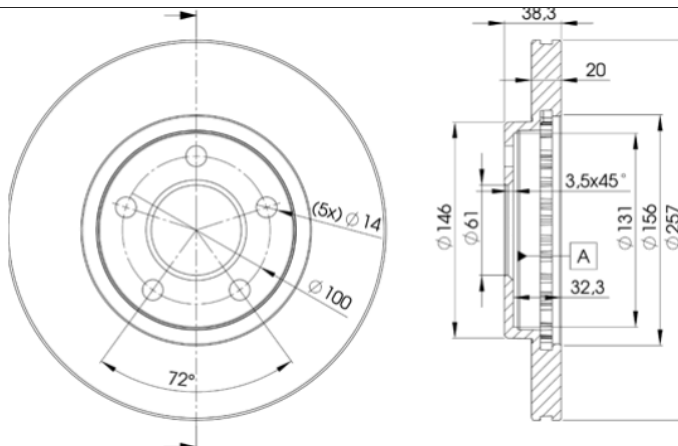

## 78BD9718-2



Ø257x20x38.3

MAKE
CHRYSLER
DODGE
PLYMOUTH



Trac.	CC	Kw	CV		
					Front / Rear

### CHRYSLER

ES 01.88-12.91						Hatchback (Compact car-C Segment)		
TURBO	Gasolina	FWD	2213	109	148	05.89-12.89	■	
2.5	Gasolina	FWD	2501	72	98	10.88-09.90	■	
2.5	Gasolina	FWD	2501	74	101	01.88-12.89	■	
GS DAYTONA SHELBY 10.84-10.92						Coupe (Compact car-C Segment)		
2.5 i Turbo (EDT)	Gasolina	FWD	2501	110	150	01.89-10.92	■	
LE BARON VI-VII 09.86-01.97						Convertible (Executive car-E Segment)		
2.2 i Turbo (EDR)	Gasolina	FWD	2213	109	148	09.86-12.90	■	
2.2 i Turbo (EDR)	Gasolina	FWD	2213	130	177	09.86-12.90	■	
2.5 i (EDM)	Gasolina	FWD	2501	75	101	09.86-12.93	■	
3.0 i V6 (6G72)	Gasolina	FWD	2972	105	143	01.90-12.96	■	
LE BARON VI-VII 01.86-12.93						Coupe (Executive car-E Segment)		
2.5 (EDM)	Gasolina	FWD	2501	75	101	09.86-12.93	■	
3.0 i V6 (EFA)	Gasolina	FWD	2972	105	143	01.90-12.93	■	
LE BARON VI-VII / PHANTOM 09.86-12.94						Saloon (Executive car-E Segment)		
2.5 i (EDM)	Gasolina	FWD	2501	75	101	01.89-12.94	■	
2.5 i Turbo (EDT)	Gasolina	FWD	2501	112	152	01.89-12.94	■	
3.0 i V6 (EFA)	Gasolina	FWD	2972	105	143	01.90-12.94	■	
NEON (PL) 05.94-09.00						Saloon (Compact car-C Segment)		
1.8 16V (EBD)	Gasolina	FWD	1796	85	116	09.97-08.99	■	
2.0 16V (420H)	Gasolina	FWD	1996	98	133	05.94-08.99	■	
2.0 16V (ECC)	Gasolina	FWD	1996	107	145	06.94-08.99	■	

# LISTA DE APLICACIONES - BUYERS GUIDE

2.0 16V (420T)		Gasolina	FWD	1996	109	148	04.96-08.99	■
2.0 16V (ECC)		Gasolina	FWD	1996	112	152	10.94-09.98	■
2.0 (ECC)		Gasolina	FWD	1996	118	160	10.96-09.00	■
<b>NEON II 08.99-12.06</b>					<b>Saloon (Compact car-C Segment)</b>			
1.8 (EBD)		Gasolina	FWD	1796	91	124	01.00-12.01	■
2.0 16V (ECB)		Gasolina	FWD	1996	97	131	10.02-12.06	■
2.0 16V R/T (ECH)		Gasolina	FWD	1996	110	150	10.01-12.06	■
2.0 16V R/T (ECH)		Gasolina	FWD	1996	112	152	10.01-12.04	■
<b>NEW YORKER XIII 09.87-12.93</b>					<b>Saloon (Luxury car-F Segment)</b>			
3.0		Gasolina	FWD	2972	105	143	09.88-12.89	■
3.3 (EGA)		Gasolina	FWD	3301	110	150	10.89-12.93	■
<b>SARATOGA II 09.89-12.95</b>					<b>Saloon (Executive car-E Segment)</b>			
2.5 (EDM)		Gasolina	FWD	2501	72	98	10.89-09.91	■
3.0 (6G72)		Gasolina	FWD	2972	105	142	09.89-12.95	■
<b>DODGE</b>								
<b>NEON 01.94-09.99</b>					<b>Coupe (Compact car-C Segment)</b>			
2.0 Highline (ECB)		Gasolina	FWD	1996	98	133	01.94-09.99	■
2.0 Sport (ECC)		Gasolina	FWD	1996	109	148	01.94-09.96	■
2.0 HP Sport (ECC)		Gasolina	FWD	1996	112	152	10.94-09.99	■
<b>NEON 05.94-08.99</b>					<b>Saloon (Compact car-C Segment)</b>			
2.0 16V (ECB)		Gasolina	FWD	1996	98	133	05.94-08.99	■
2.0 16V (ECC)		Gasolina	FWD	1996	107	145	06.94-08.99	■
2.0 16V (ECC)		Gasolina	FWD	1996	109	148	04.96-08.99	■
2.0 16V (ECC)		Gasolina	FWD	1996	112	152	04.96-08.99	■
<b>NEON II 08.99-</b>					<b>Saloon (Compact car-C Segment)</b>			
2.0 16V (ECB)		Gasolina	FWD	1996	98	133	08.99-	■
2.0 (ECH)		Gasolina	FWD	1996	110	150	10.99-09.05	■
2.0 16V (ECH)		Gasolina	FWD	1996	112	152	08.99-12.02	■
<b>PLYMOUTH</b>								
<b>NEON 10.94-09.99</b>					<b>Coupe (Compact car-C Segment)</b>			
2.0 (ECB)		Gasolina	FWD	1996	98	133	10.94-09.99	■
2.0 (ECC)		Gasolina	FWD	1996	107	145	10.94-09.99	■
<b>NEON 05.94-08.99</b>					<b>Saloon (Compact car-C Segment)</b>			
2.0 16V (ECB)		Gasolina	FWD	1996	98	133	05.94-08.99	■
2.0 16V (ECC)		Gasolina	FWD	1996	107	145	06.94-08.99	■
2.0 16V (ECC)		Gasolina	FWD	1996	112	152	04.96-08.99	■
<b>NEON II 08.99-</b>					<b>Saloon (Compact car-C Segment)</b>			
2.0 16V (ECB)		Gasolina	FWD	1996	98	133	08.99-	■
2.0 16V (ECH)		Gasolina	FWD	1996	112	152	09.99-09.05	■
<b>SUNDANCE 03.86-09.94</b>					<b>Coupe (Compact car-C Segment)</b>			
2.2 (EDF)		Gasolina	FWD	2213	67	91	10.89-09.94	■
2.2 (EDF)		Gasolina	FWD	2213	72	98	03.86-09.89	■
2.2 Turbo		Gasolina	FWD	2213	109	148	03.86-09.89	■
2.2 Turbo (EDR)		Gasolina	FWD	2213	129	175	10.89-09.91	■
<b>SUNDANCE 03.86-09.94</b>					<b>Saloon (Compact car-C Segment)</b>			
2.2 (EDF)		Gasolina	FWD	2213	67	91	10.89-09.94	■
2.2 (EDF)		Gasolina	FWD	2213	72	98	03.86-09.89	■

## LISTA DE APLICACIONES - BUYERS GUIDE

2.2 Turbo	Gasolina	FWD	2213	109	148	03.86-09.89	■
2.2 Turbo (EDR)	Gasolina	FWD	2213	129	175	10.89-09.91	■